



US00D896707S

(12) **United States Design Patent**
Buell

(10) **Patent No.:** **US D896,707 S**

(45) **Date of Patent:** **** Sep. 22, 2020**

(54) **MOTOCYCLE**

(71) Applicant: **FUELL Inc.**, New York, NY (US)

(72) Inventor: **Erik Buell**, Mukwonago, WI (US)

(73) Assignee: **FUELL Inc.**, New York, NY (US)

(**) Term: **15 Years**

(21) Appl. No.: **29/681,991**

(22) Filed: **Feb. 28, 2019**

(51) **LOC (12) Cl.** **12-11**

(52) **U.S. Cl.**
USPC **D12/114**

(58) **Field of Classification Search**
USPC D12/114, 110, 107, 117, 119, 126, 222,
D12/223

CPC B62K 11/04; B62K 11/02; B62K 11/00;
B62K 19/12; B62K 25/04; B62J 7/04;
B62J 1/12; B62J 1/28

See application file for complete search history.

(56) **References Cited**

U.S. PATENT DOCUMENTS

D497,332 S *	10/2004	Sugimoto	D12/114
D503,363 S *	3/2005	Alsop	D12/117
D509,462 S *	9/2005	Ford	D12/117
D516,470 S *	3/2006	Clements	D12/114
D520,414 S *	5/2006	Tanaka	D12/119
D521,418 S *	5/2006	Lee	D12/114
D521,419 S *	5/2006	Mezzasalma	D12/117

D527,314 S *	8/2006	Czysz	D12/117
D541,706 S *	5/2007	Goldstein	D12/117
D542,191 S *	5/2007	Alsop	D12/117
D544,409 S *	6/2007	Hutchison	D12/114
D583,717 S *	12/2008	Brown	D12/117
D737,729 S *	9/2015	Seo	D12/114
D786,739 S *	5/2017	Fujimoto	D12/110

* cited by examiner

Primary Examiner — Michelle E. Wilson

Assistant Examiner — Clese Moore, Jr.

(74) *Attorney, Agent, or Firm* — Banner & Witcoff, Ltd.

(57) **CLAIM**

The ornamental design for a motorcycle, as shown and described.

DESCRIPTION

FIG. 1 is a top, front, right perspective view of a motorcycle showing my new design;

FIG. 2 is a right side view thereof;

FIG. 3 is a top view thereof;

FIG. 4 is a rear right perspective view thereof; and,

FIG. 5 is an enlarged view of FIG. 4 with environment removed to enhance clarity.

The broken lines immediately adjacent to the shaded area represent unclaimed boundaries of the design. The broken lines showing the remainder of the motorcycle represent unclaimed subject matter and form no part of the claimed design. Pursuant to MPEP 608.02(VIII), FIGS. 1-5 are lined for the color orange.

1 Claim, 5 Drawing Sheets

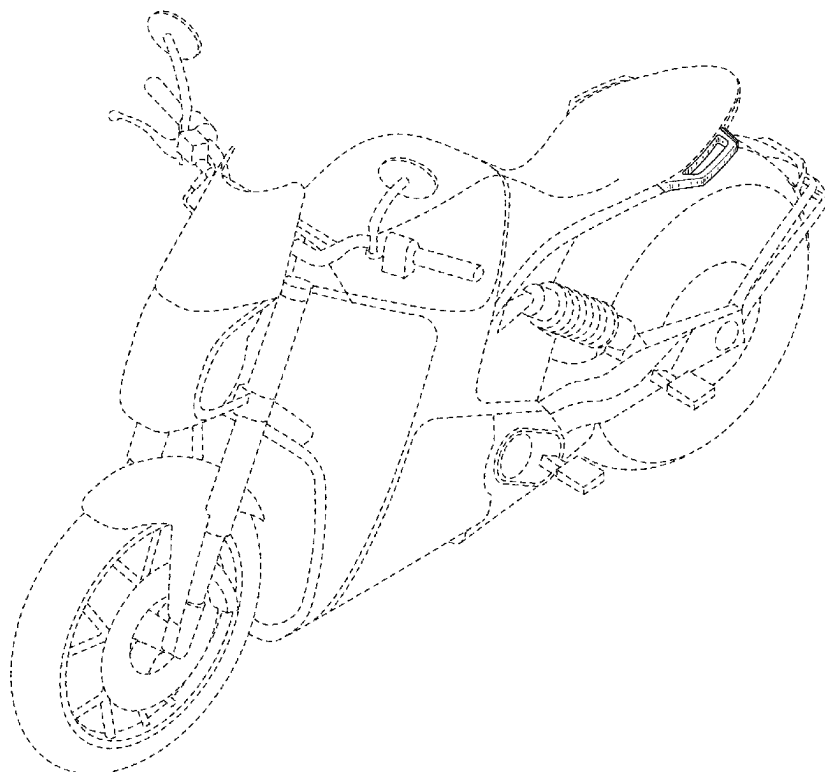

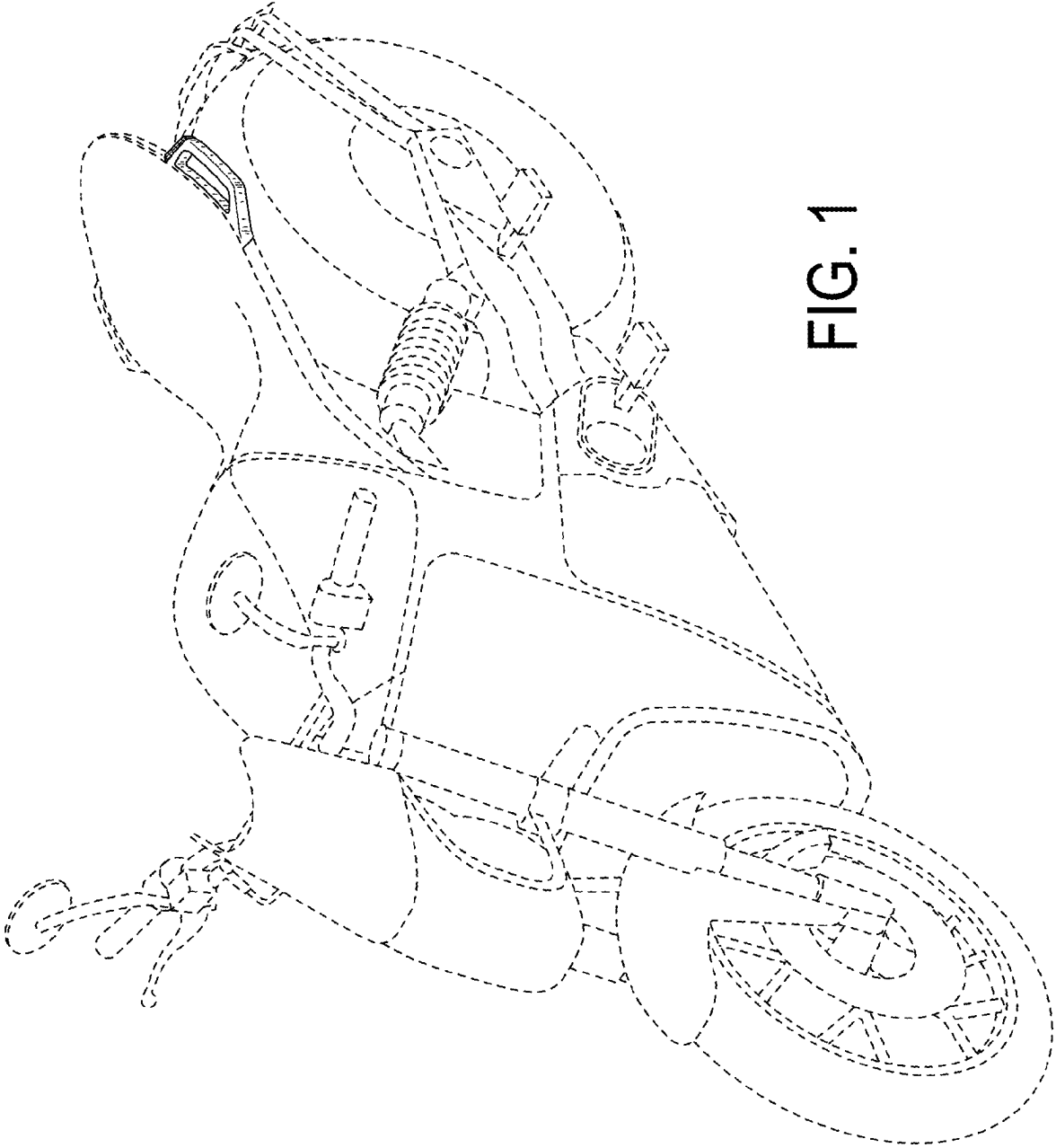

FIG. 1

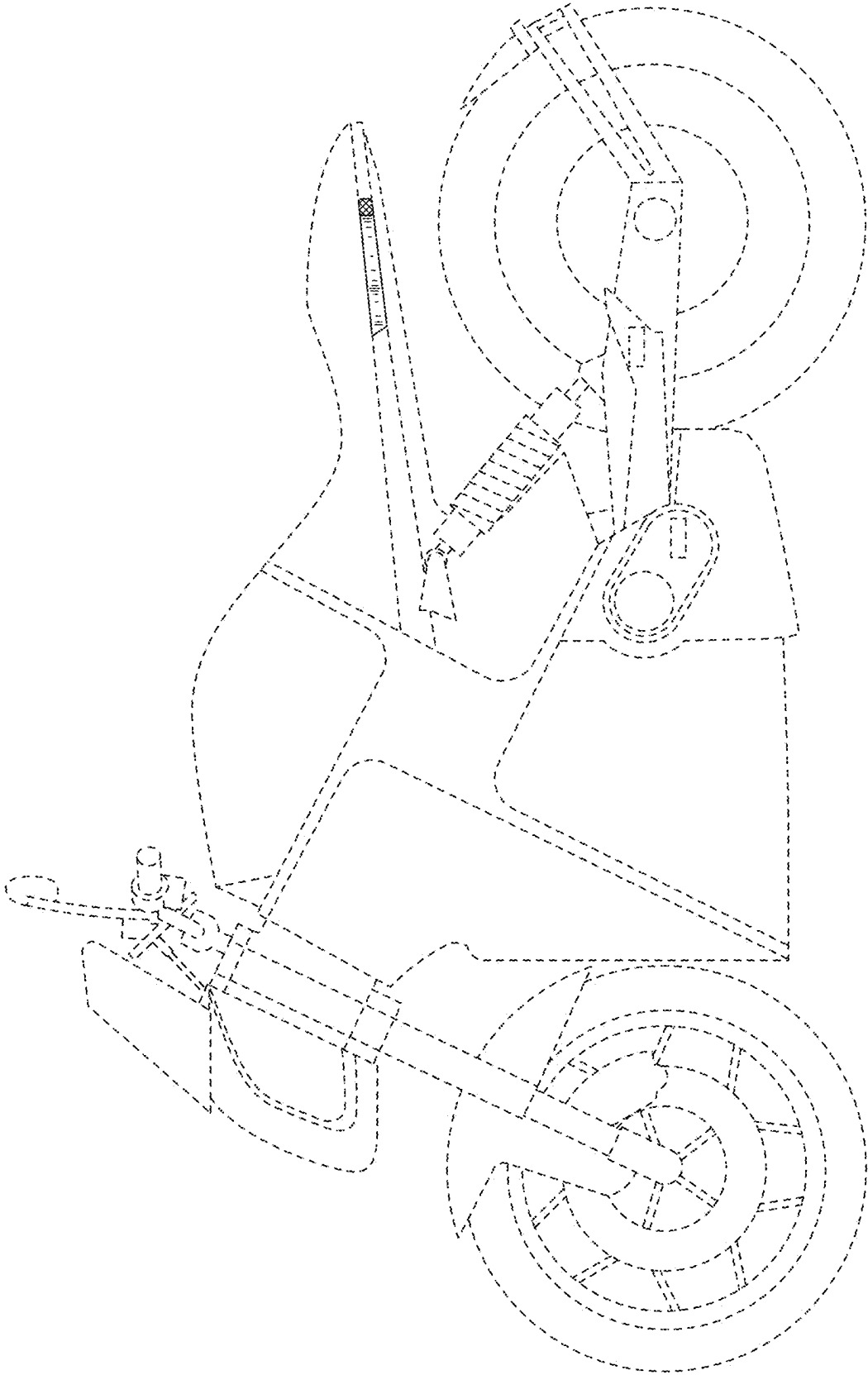

FIG. 2

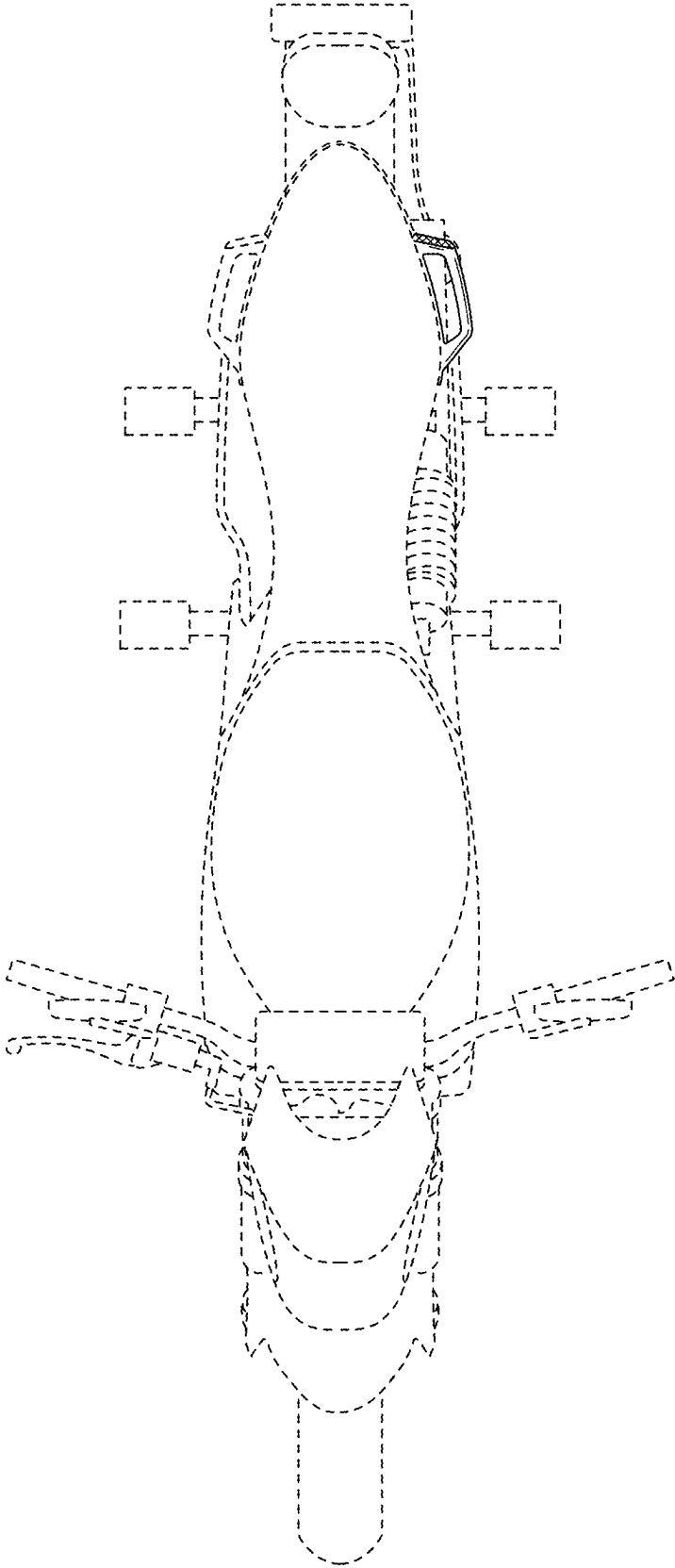
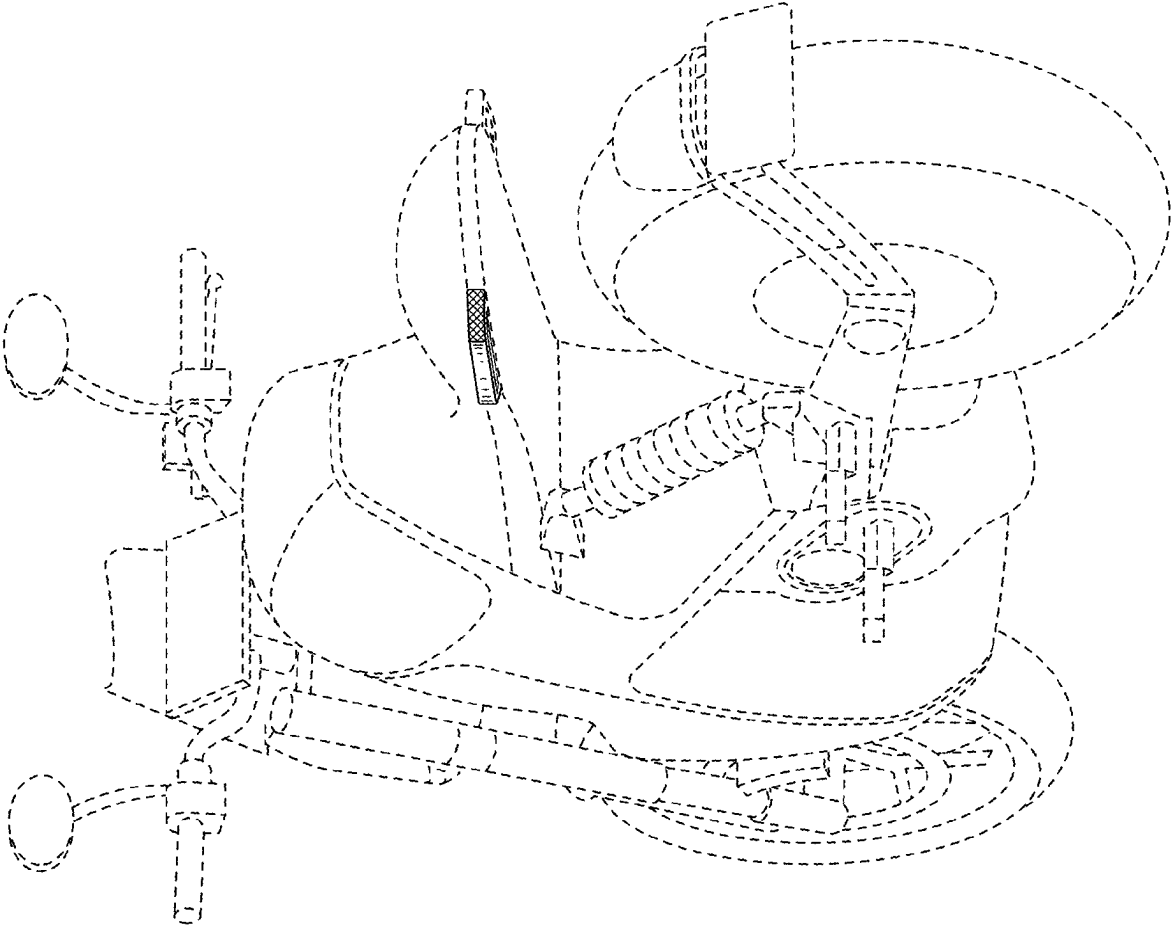

FIG. 3

FIG. 4



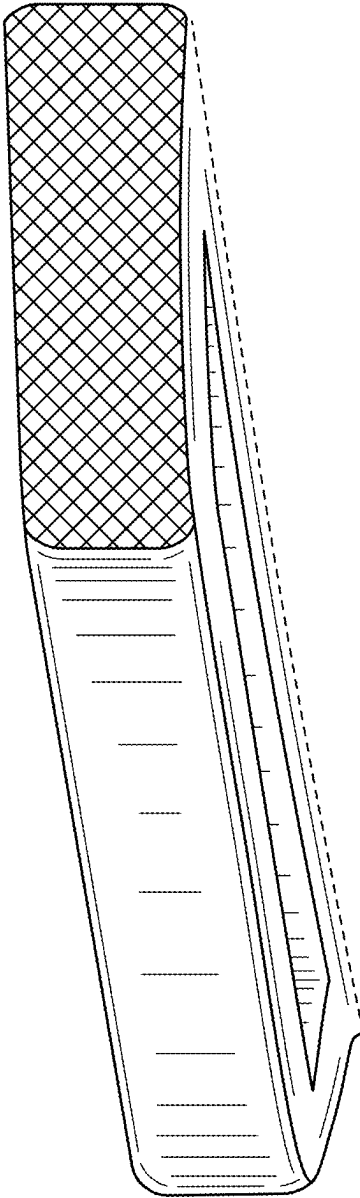

FIG. 5