



US00D893358S

(12) **United States Design Patent**  
**Buell**

(10) **Patent No.:** **US D893,358 S**

(45) **Date of Patent:** **\*\* Aug. 18, 2020**

(54) **MOTORCYCLE**

(71) Applicant: **FUELL Inc.**, New York, NY (US)

(72) Inventor: **Erik Buell**, Mukwonago, WI (US)

(73) Assignee: **FUELL Inc.**, New York, NY (US)

(\*\*) Term: **15 Years**

(21) Appl. No.: **29/681,969**

(22) Filed: **Feb. 28, 2019**

(51) **LOC (12) Cl.** ..... **12-11**

(52) **U.S. Cl.**  
USPC ..... **D12/114**

(58) **Field of Classification Search**  
USPC ..... D12/114, 110, 107, 117, 119, 126, 222,  
D12/223  
CPC ..... B62K 11/04; B62K 11/02; B62K 11/00;  
B62K 19/12; B62K 25/04; B62J 7/04;  
B62J 1/12; B62J 1/28  
See application file for complete search history.

(56) **References Cited**

**U.S. PATENT DOCUMENTS**

D497,332 S *	10/2004	Sugimoto	.....	D12/114
D503,363 S *	3/2005	Alsop	.....	D12/117
D509,462 S *	9/2005	Ford	.....	D12/117
D516,470 S *	3/2006	Clements	.....	D12/114
D520,414 S *	5/2006	Tanaka	.....	D12/119
D521,418 S *	5/2006	Lee	.....	D12/114
D521,419 S *	5/2006	Mezzasalma	.....	D12/117
D527,314 S *	8/2006	Czysz	.....	D12/117

D541,706 S *	5/2007	Goldstein	.....	D12/117
D542,191 S *	5/2007	Alsop	.....	D12/117
D544,409 S *	6/2007	Hutchison	.....	D12/114
D583,717 S *	12/2008	Brown	.....	D12/117
D737,729 S *	9/2015	Seo	.....	D12/114
D786,739 S *	5/2017	Fujimoto	.....	D12/110

\* cited by examiner

*Primary Examiner* — Michelle E. Wilson

*Assistant Examiner* — Clese Moore, Jr.

(74) *Attorney, Agent, or Firm* — Banner & Witcoff, Ltd.

(57) **CLAIM**

The ornamental design for a motorcycle, as shown and described.

**DESCRIPTION**

FIG. 1 is a top, front, right perspective view of a motorcycle showing my new design;  
FIG. 2 is a right side view thereof;  
FIG. 3 is a left side view thereof;  
FIG. 4 is a top view thereof;  
FIG. 5 is a rear, right side view thereof;  
FIG. 6 is a rear, left side view thereof; and,  
FIG. 7 is an enlarged view of FIG. 5 with environment removed to enhance clarity.

The broken lines adjacent to the shaded area define the bounds of the claimed design and form no part thereof. The broken lines depicting the remainder of the motorcycle show features that form no part of the claimed design.

**1 Claim, 7 Drawing Sheets**

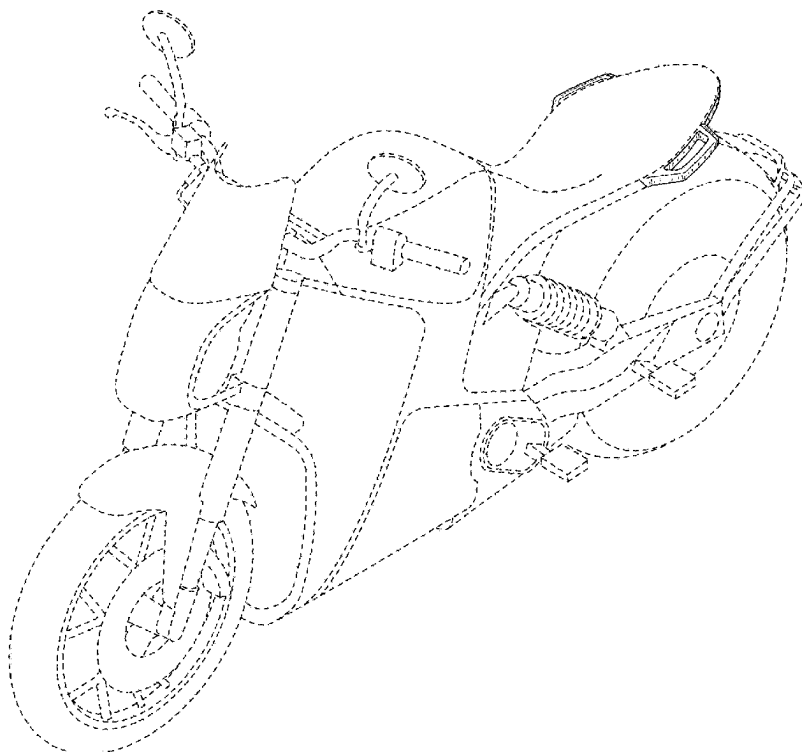

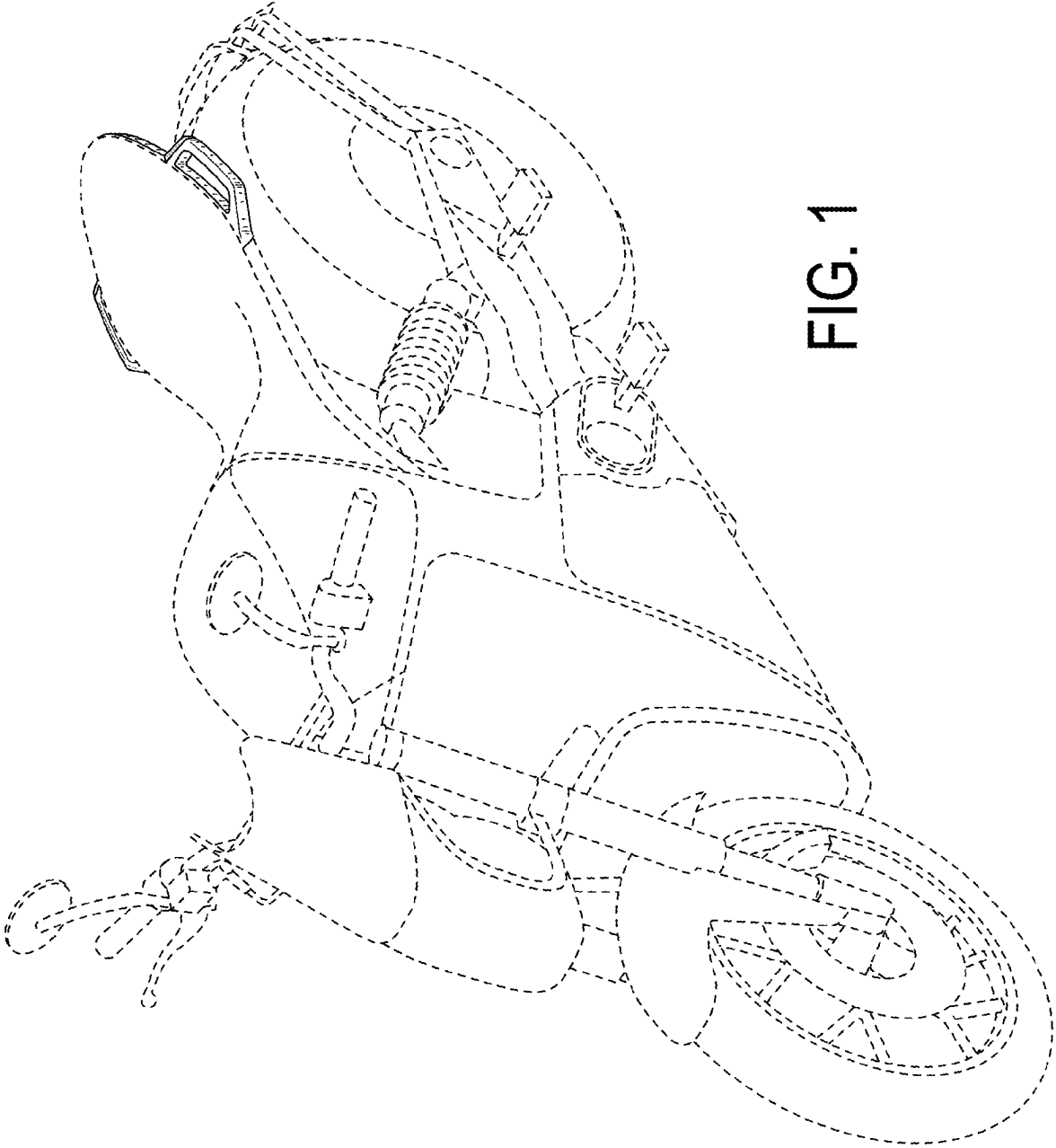

FIG. 1

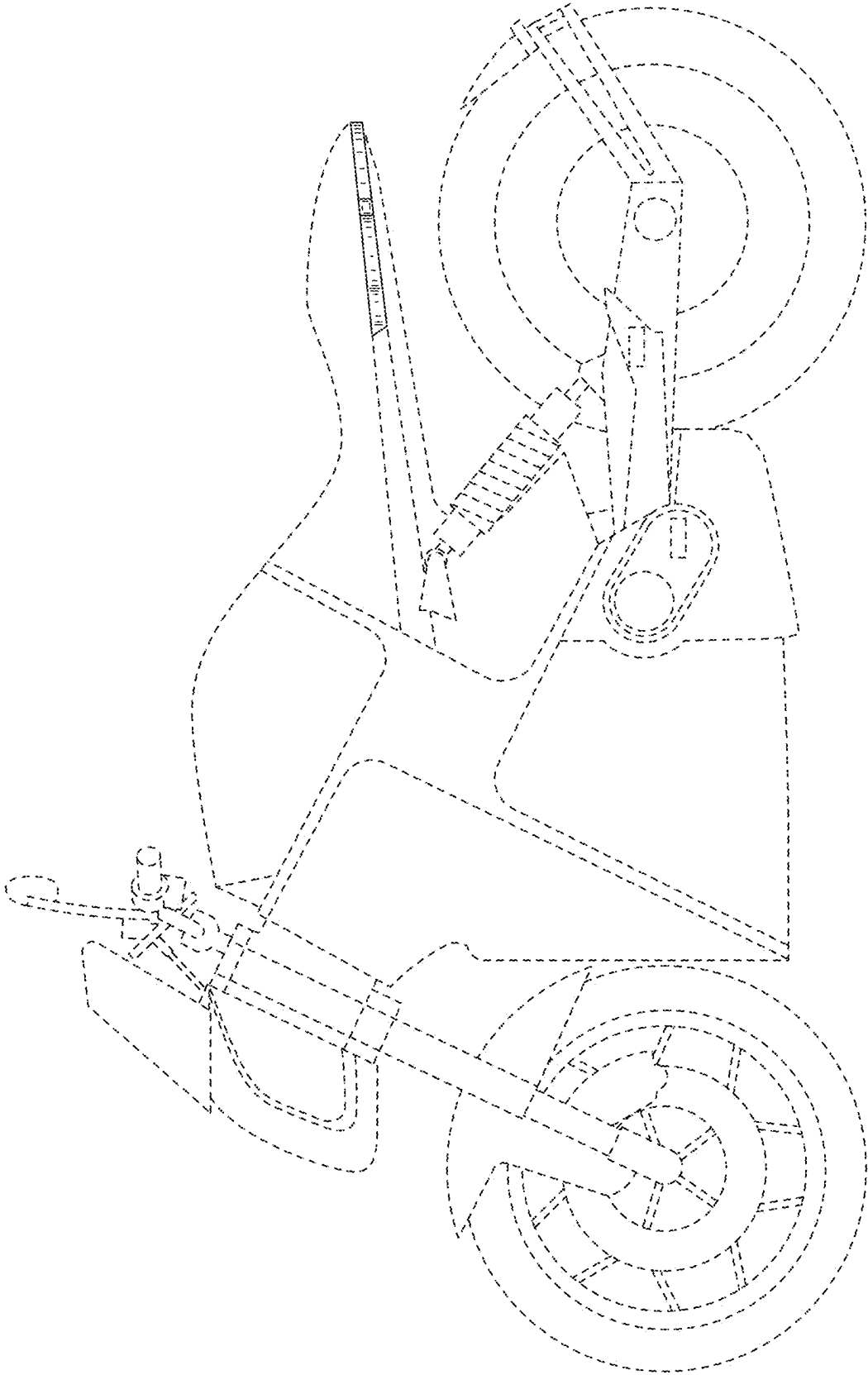

FIG. 2

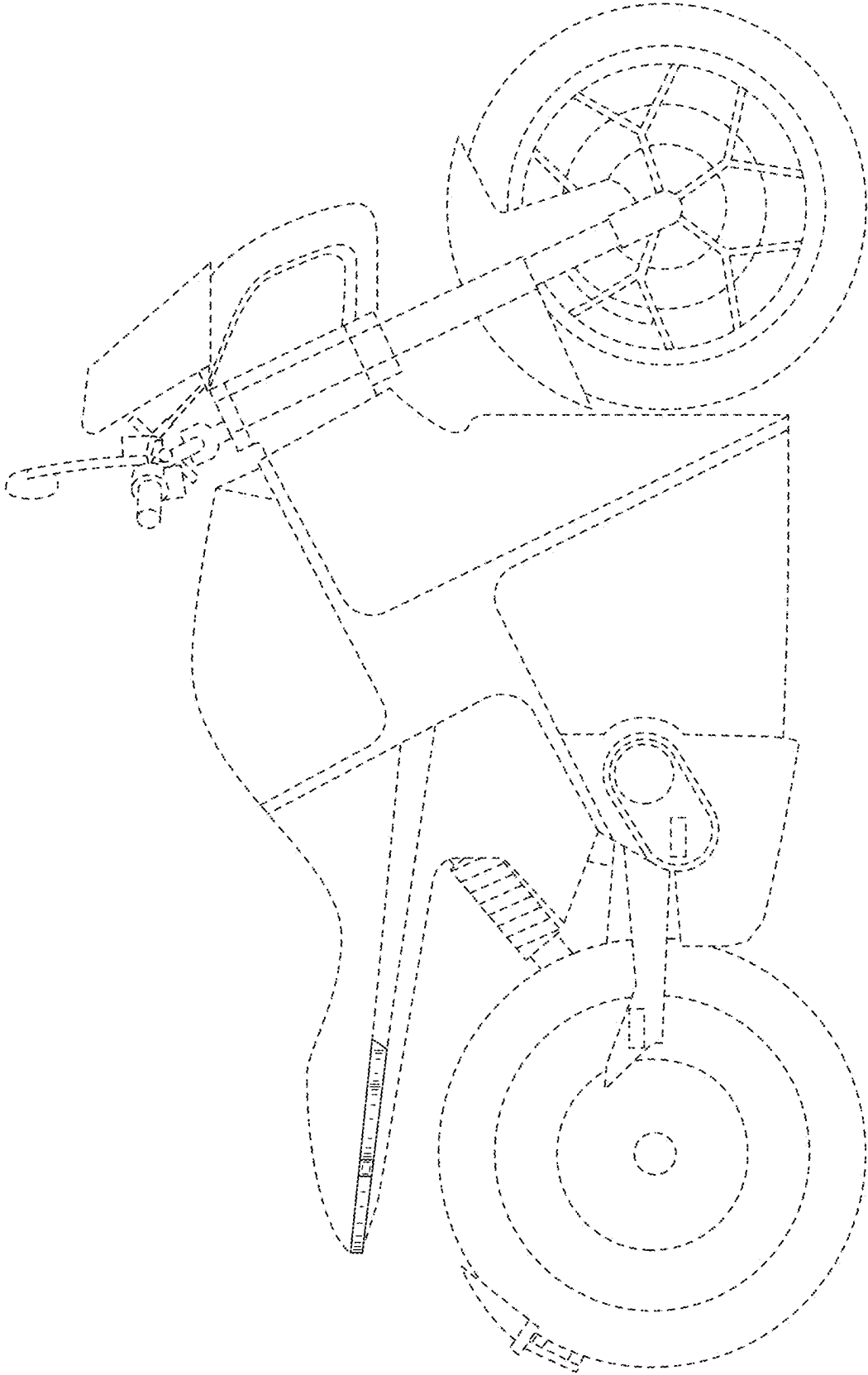

FIG. 3

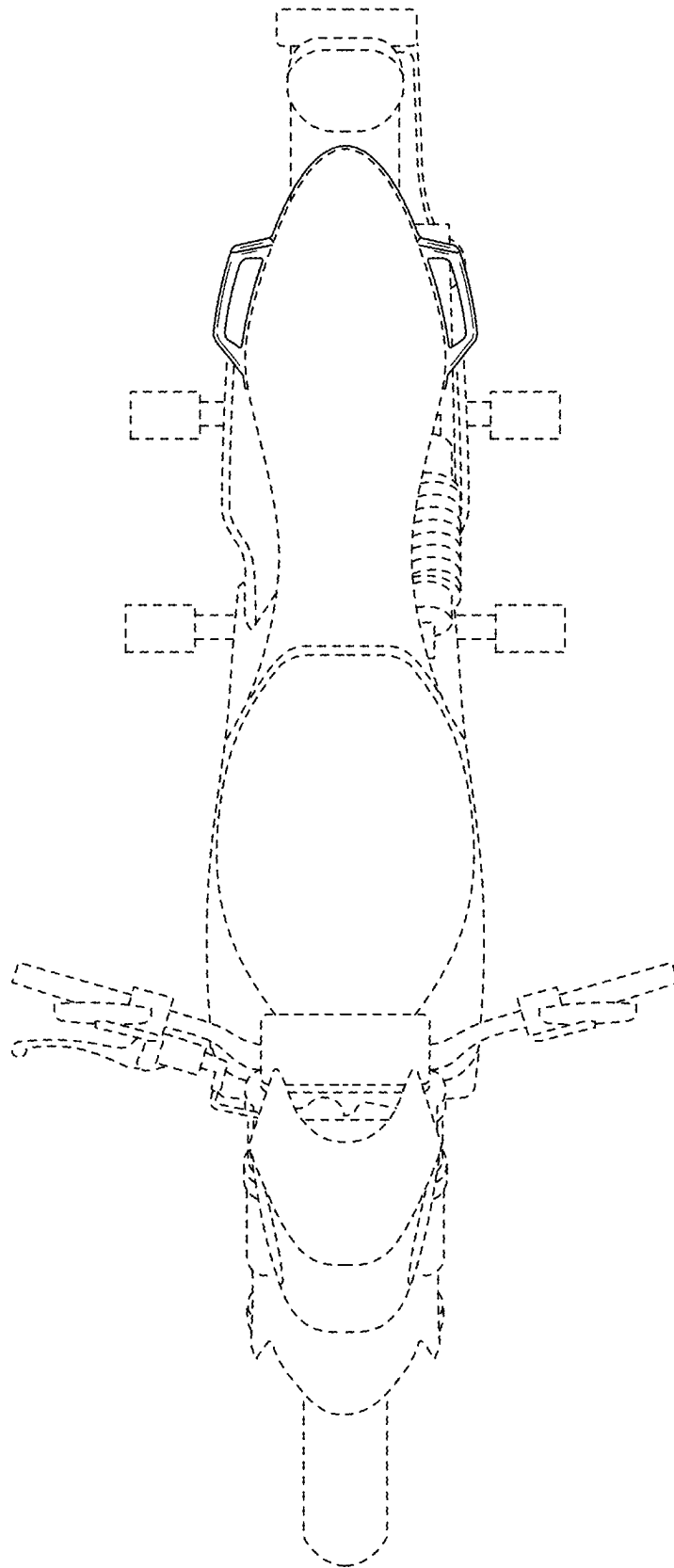

FIG. 4

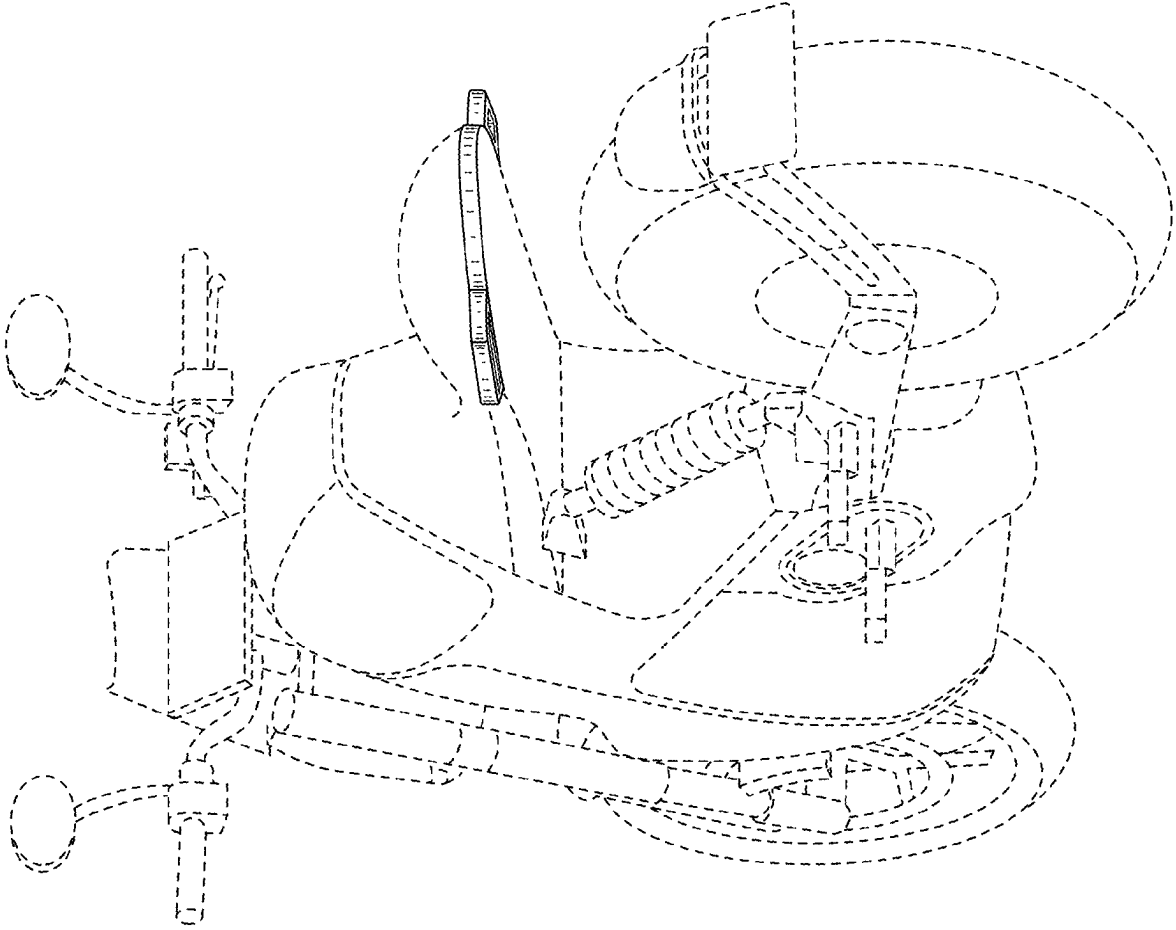

FIG. 5

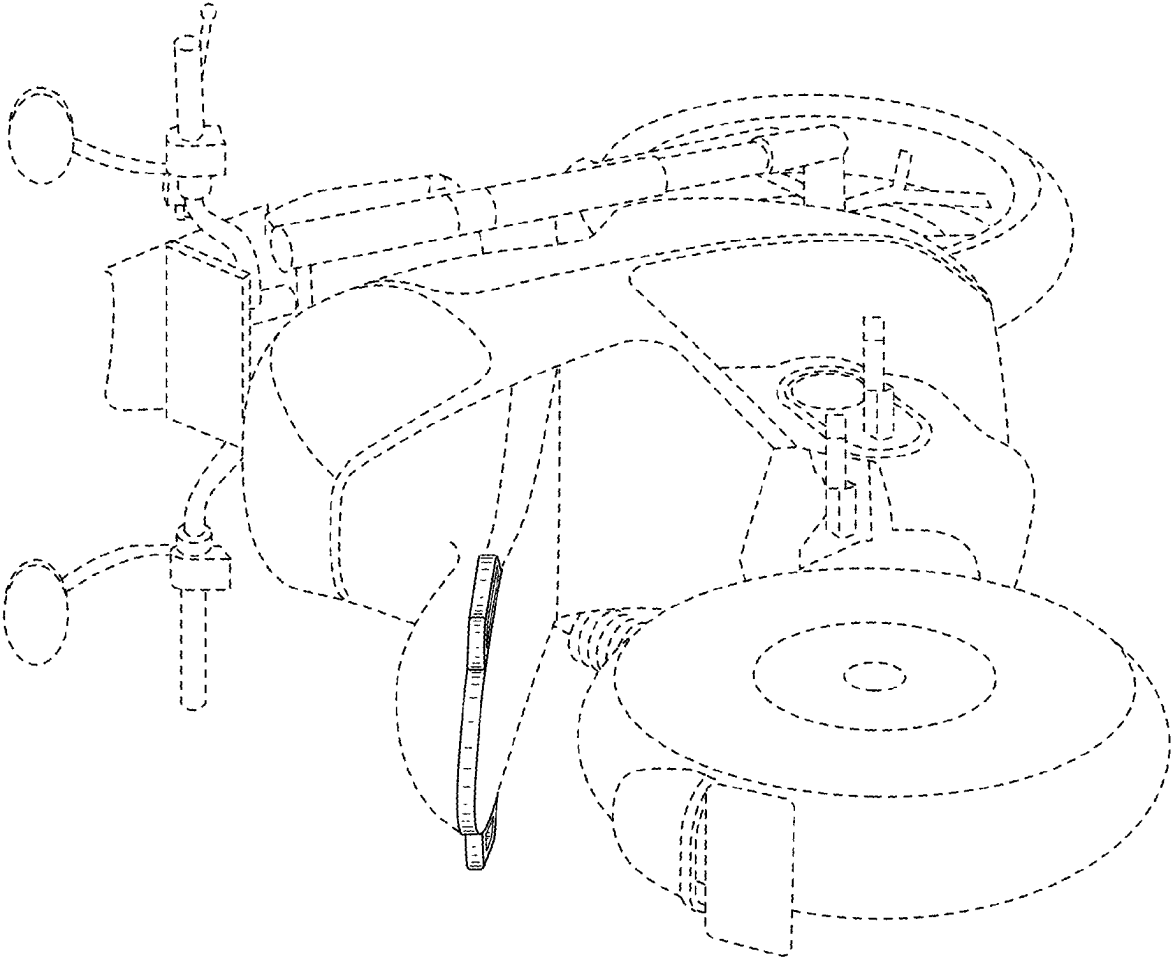

FIG. 6

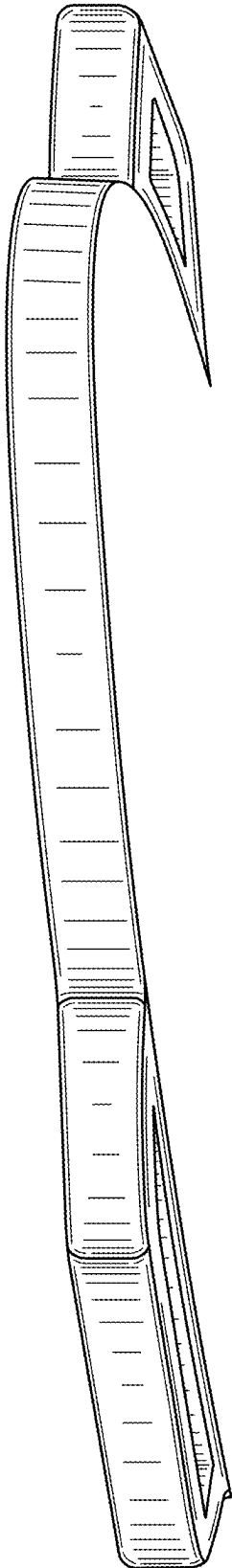

FIG. 7